

- NOTE:**
- Interior and exterior ferrous metal surfaces epoxy coated to comply with the AWWA C550 Standard.
 - Standard with handwheel on flanged valves.
 - 2 inch op nut with mechanical joint valves
 - Handwheel optional
 - Pentagon ballons refer to items only related to 30 and 36 inch valves
 - 304 stainless steel fasteners are standard, 316 SS available upon request

ITEM NO.	PART NUMBER	ASTM DESIGNATION
1	Body - Flanged	A536 GR. 65-45-12 OR 70-50-05
2	Plug	A536 GR. 65-45-12 OR 70-50-05
3	Cover	A536 GR. 65-45-12 OR 70-50-05
4	Bottom Thrust	PTFE
5	Bottom Bearing	SINTERED ALLOY SS316
6	GRIT GUARD SHAFT SEAL (LOWER)	NBR
7	GRIT GUARD SHAFT SEAL (UPPER)	NBR
8	Upper thrust	PTFE
9	Upper Bearing	SINTERED ALLOY SS316
10	30-36-V2-packing-AN6225-55	NBR
11	30-36-V2-top-packing-AN6225-55	NBR
12	30-36-V-bottom-packing-AN6225-55	NBR
13	Gland (for Actuator)	A536 GR. 65-45-12 OR 70-50-05
14	Bottom Cover	A536 GR. 65-45-12 OR 70-50-05
15	Cover Studs	A276 T304 OR T316
16	Top Cover Bolts	A276 T304 OR T316
17	Bottom Cover Bolts	A276 T304 OR T316
18	Adaptor Bolts	A276 T304 OR T316
19	Cover Stud Nuts	A276 T304 OR T316
20	O-Ring Bottom Cover	NBR
21	O-ring Top Cover	NBR
22	Adaptor - Close	A536 GR. 65-45-12 OR 70-50-05

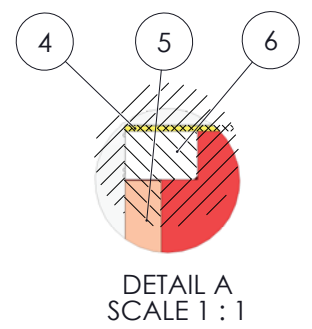

DETAIL B
SCALE 1 : 4

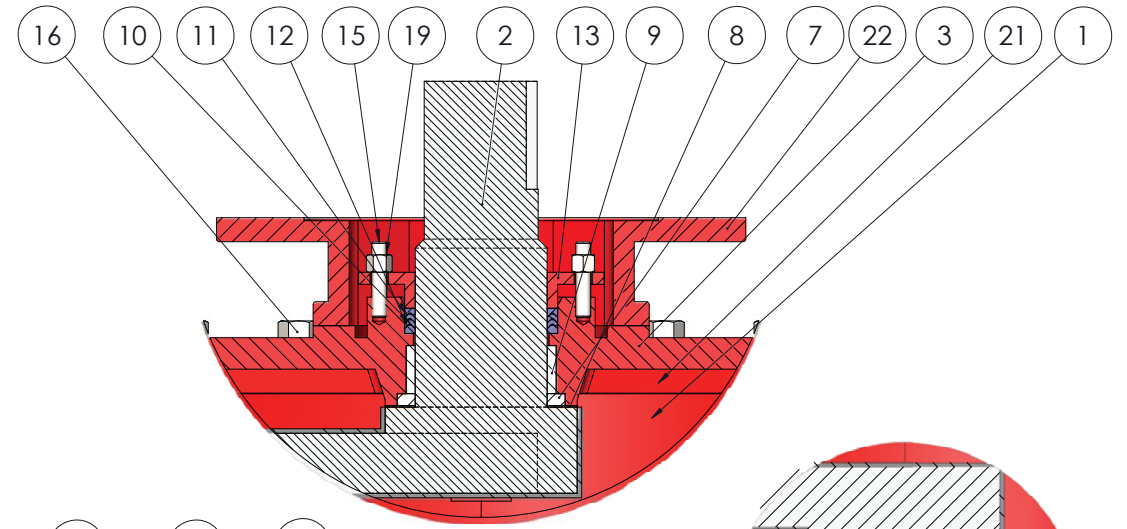
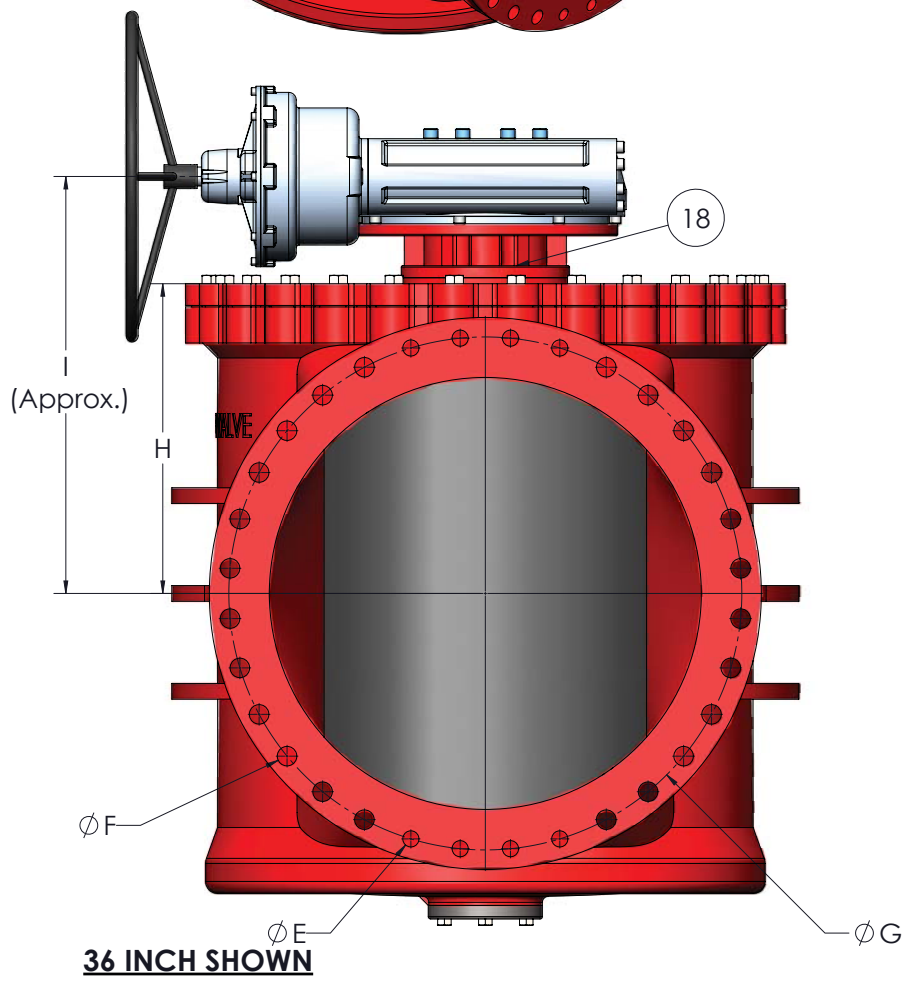
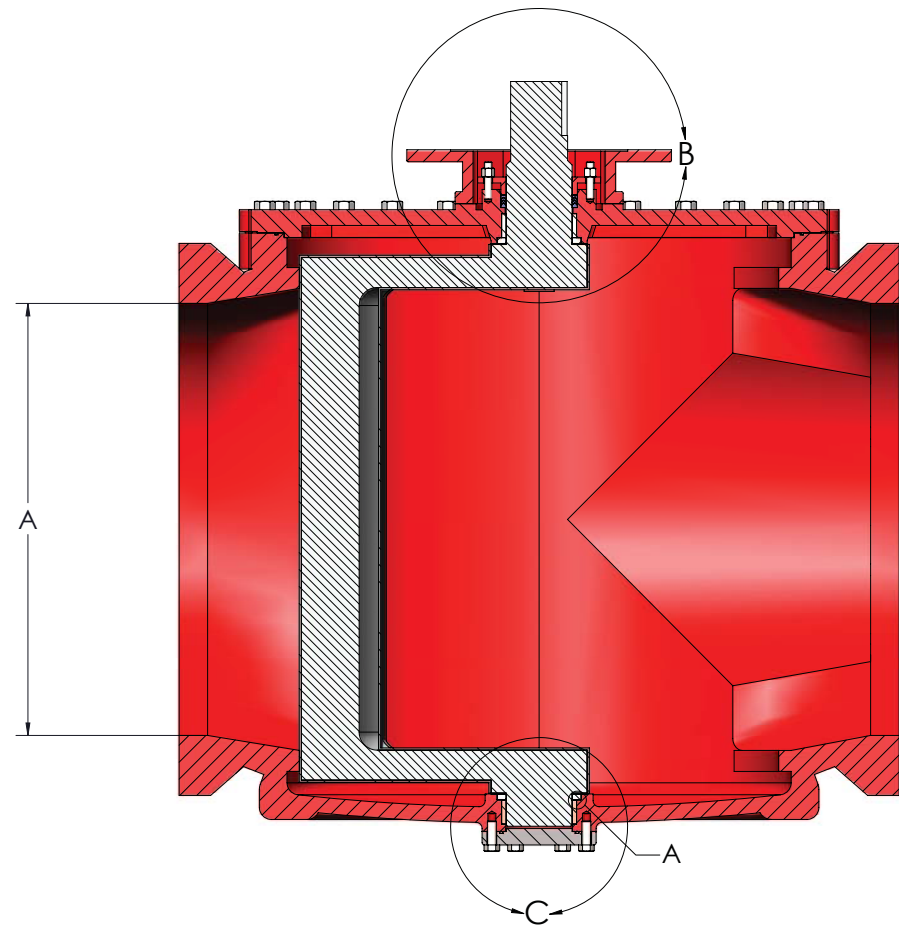
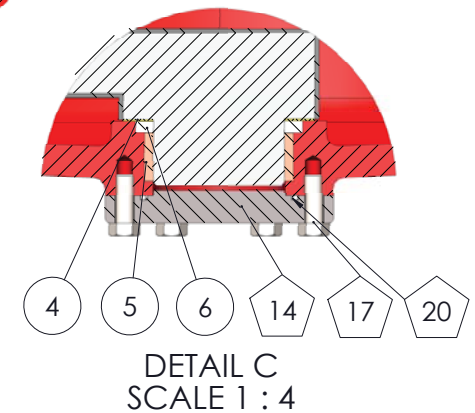

DETAIL C
SCALE 1 : 4

A [VALVE SIZE]	B	C	D	E	F	G	H	I	WEIGHT [LBS]	ROTORK GEAR	GEAR RATIO	ROTORK HANDWHEEL	Cv AVG. [U.S. gal/min]	WATER WORKING PRESSURE PSI	HYDROSTATIC TEST PSI	FLANGE ISO
14	17.00	1.38	Ø21.00	8 x 1.00-8 UNS-2B ▽1.54	4 x Ø1.13 THRU	Ø18.75	12.88	18.00	720	AB2000N	109:1	SG400	5789	150 PSI	300 PSI	F16
16	17.75	1.44	Ø23.50	8 x 1.00-8 UNS-2B ▽1.06	8 x Ø1.13 THRU	Ø21.25	14.69	22.50	850	AB2000N	109:1	SG400	6956	150 PSI	300 PSI	F16
18	21.50	1.58	Ø25.00	8 x 1.13-7 UNS-2B ▽1.50	8 x Ø1.25 THRU	Ø22.75	16.42	21.50	1150	AB2000LB	109:1	SG600	7872	150 PSI	300 PSI	F25
20	23.50	1.69	Ø27.50	8 x 1.13-7 UNS-2B ▽1.25	12 x Ø1.25 THRU	Ø25.00	17.09	22.25	1425	AB1950N/PR4	217:1	SG600	12370	150 PSI	300 PSI	F25
24	42.00	1.88	Ø32.00	8 x 1.25-7 UNS-2B ▽2.00	12 x Ø1.38 THRU	Ø29.50	21.06	28.00	3150	AB3000NLB/PR4	243:1	SG600	30930	150 PSI	300 PSI	F30
30	51.00	2.13	Ø38.75	8 x 1.25-7 UNS-2B ▽2.63	20 x Ø1.38 THRU	Ø36.00	22.19	30.69	5700	IW82	720:1	F700	48774	150 PSI	300 PSI	F35
36	60.00	2.38	Ø46.00	8 x 1.50-6 UNS-2B ▽3.50	24 x Ø1.63 THRU	Ø42.75	25.81	34.75	12,000	IW9	960:1	F700	74595	150 PSI	300 PSI	F40
48	84.00	2.75	Ø59.50	8 x 1.50-6 UNS-2B ▽4.00	36 x Ø1.63 THRU	Ø56.00	27.08	36.75	23,520	IW11	1080:1	F800	-	150 PSI	300 PSI	F40

48" DIMENSIONS ARE FOR QUOTING ONLY

ZONE	REV.	DESCRIPTION	DATE	APPROVED
	1	RELEASED	8/6/15	ML
	2	UPDATED TABLE FOR GEARING	8/14/2015	CW
	3	ADDED NOTE FOR 316SS FASTENERS	9/14/2015	ML
	-	ADDED 48" QUOTING DIMENSIONS	4/20/2016	CAW
	4	UPDATED 48 INCH OAL FROM 80" TO 84"	5/4/2016	ML
	5	UPDATED 36 INCH TABLE "F" TO 24X FROM 36X	8/18/2016	ML

DRAWN		NAME	DATE	KENNEDY VALVE Division of McWane, Inc. 1021 EAST WATER STREET ELMIRA, NEW YORK 14901
CHECKED		CAW	7/20/2015	
APPROVED		ML	8/6/2015	
MATERIAL: SEE TABLE				TITLE:
Weight: SEE TABLE				14"-48" "FULL FLOW" FLG EPV (6412-FF) w/ ROTORK GEAR
DO NOT SCALE DRAWING				SIZE: D
THE INFORMATION CONTAINED IS THE SOLE PROPERTY OF KENNEDY VALVE CO. ANY REPRODUCTION IN PART OR AS A WHOLE WITHOUT THE WRITTEN PERMISSION OF KENNEDY VALVE CO. IS PROHIBITED. DESIGN & INVENTION RIGHTS RESERVED.				DWG. NO. SUB910207T
PROPRIETARY AND CONFIDENTIAL				REV 5
SHEET 1 OF 1				