

Size (inch)  
ARD  
300 PSI  
AWWA C500  
DI

SC.I.  
DI  
200

Detail A  
Body Seal Screwed In

Remark - End flanges mechanical joint conform to ANSI/AWWA C111/A2.11  
- Dimensions in inches

SIZE Ød In.	L	ØD	ØC	Ød1	Øh	n	h1	n1	T	A	H	H1	H2	H3	ØW	By pass size
14	15	20.31	18.75	15.44	7/8	6	7/8	4	1.31	22.75	43.88	14.62	12.69	-	15.75	-
16	18	22.56	21	17.54	7/8	6	7/8	6	1.38	26	51.69	16.64	14.38	25.79	17.75	3
18	20	24.83	23.25	19.64	7/8	6	7/8	6	1.44	29.29	55.00	18.71	15.69	27.88	17.75	3
20	20	27.08	25.50	21.74	7/8	6	7/8	8	1.50	32.52	59.05	20.79	17.56	27.88	17.75	3
24	24	31.58	30	25.94	7/8	8	7/8	8	1.62	36.54	69.49	22.05	24.73	32.63	19.69	4

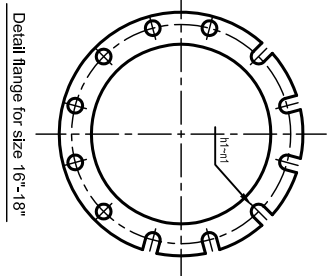
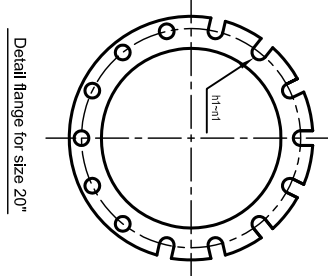
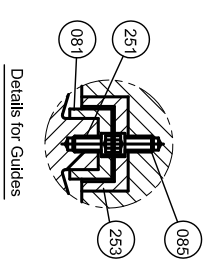

NO.	PARTS	MATERIAL	ASTM DESIGNATION	QTY
432	Packing Box Bolt	Zinc Coated Steel	A 307 Grade B	1 set
350	O-Ring	Rubber (Buna N)	D 2000 BK 707	1
345	Packing	Braded Packing Synthetic Yarn with PTFE		1
320	Bonnet Gasket	Non Asbestos Sheet		1
253	Disc Guide	Bronze	B 62	2
251	Body Guide Bolt	Zinc Coated Steel	A 307 Grade B	1 set
181	Top Nut	Zinc Coated Steel	A 307 Grade B	1
178	Gland Bolt & Nut	Zinc Coated Steel	A 307 Grade B	2
168	Stem	Stainless Steel	A 276 Type 316	1
174	Bonnet Bolt & Nut	Zinc Coated Steel	A 307 Grade B	1 set
085	Disc Guide Bolt	Zinc Coated Steel	A 307 Grade B	1 set
082	Bonnet Guide	Bronze	B 62	2
081	Body Guide	Bronze	B 62	2
071	Stem Nut	Bronze	B 62	1
069	Gland Bushing	Bronze	B 62	1
067	Packing Box Bushing	Bronze	B 62	1
066	Bonnet Bushing	Bronze	B 62	1
062	Disc Seal Ring	Bronze	B 62	2
061	Body Seal Ring	Bronze	B 62	2
049	Gear Operator			1 set
010	Operating Nut	Cast Iron	A 126 Class B	1
005	Gland	Ductile Iron	A 536 Gr.65-45-12	1
004	Packing Box	Ductile Iron	A 536 Gr.65-45-12	1
003	Disc	Ductile Iron	A 536 Gr.65-45-12	1
002	Bonnet	Ductile Iron	A 536 Gr.65-45-12	1
001	Body	Ductile Iron	A 536 Gr.65-45-12	1

HYDRO SHELL	550 PSI.
HYDRO VALVE SEAT	300 PSI.
HYDRO BACK SEAT	PSI.
WORKING PRESSURE	300 PSI.

**AMERICAN R/D**  
A DIVISION OF McIVANE INC.  
1800 GREENBRIER DEAR ROAD, ANNISTON, AL 36207  
PHONE (256)831-2236 - FAX (256)831-2884

TITLE:  
**14" - 24" SOLID WEDGE GATE VALVE - NRS - MJ END -  
SPUR GEAR-SIDE BYPASS-SERIES 100**

TYP: SWGV  
SCALE: NONE  
DWG. NO.: 100-14-24-MJ-SGSBP  
DATE: 4/20/11