

300C RESTRAINER ASSEMBLY INSTRUCTIONS

1. Insert pipe into the mechanical joint hub. Place the threaded rod through a mechanical joint bell hole and mark a line on the pipe one inch from the end of the rod.

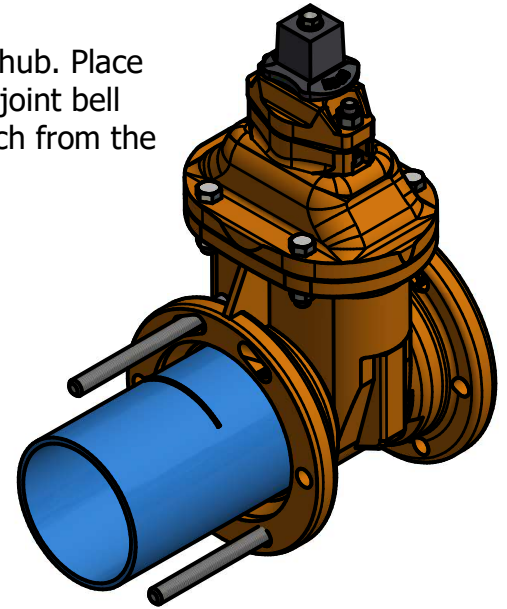
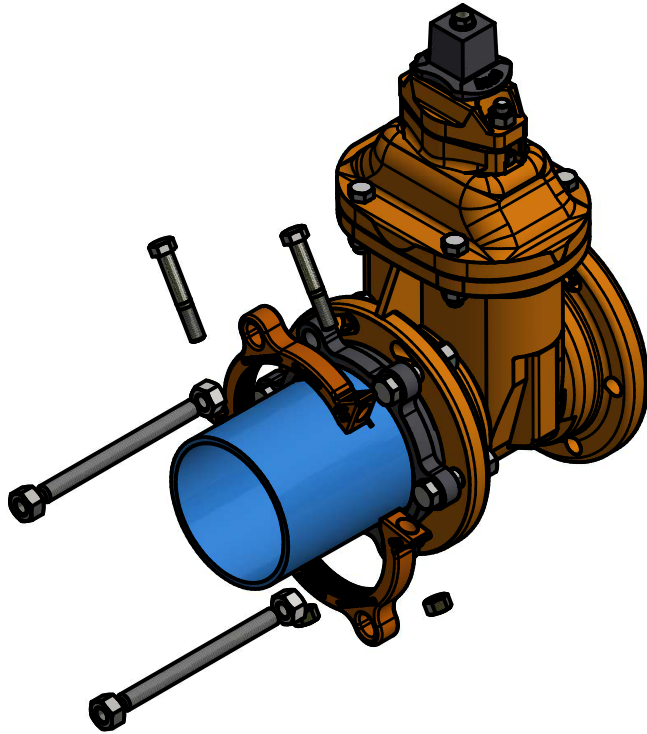

2. Assemble the follower gland, according to AWWA specifications, omitting the rods. Place the clamps onto pipe, aligning rings to marks and placing hex head clamp bolts through clamp ears insuring bolt end threads are exposed.

DO NOT TIGHTEN CLAMPING BOLTS, LEAVE LOOSE.

3. Insert the rods with nuts insuring one nut is between the follower gland and the split clamp. Tighten the follower gland nut per AWWA specifications. Install a second nut onto the exposed threads of the long rod and loosely tighten against the clamp's outside face. Tighten the clamping bolt nuts insuring equal gaps exist between the two halves. Torque clamping bolts to the following torque requirements:

4" - 6" clamps (100 ft-lbs)
8" clamps (150 ft-lbs)
10" - 12" clamps (200 ft-lbs)

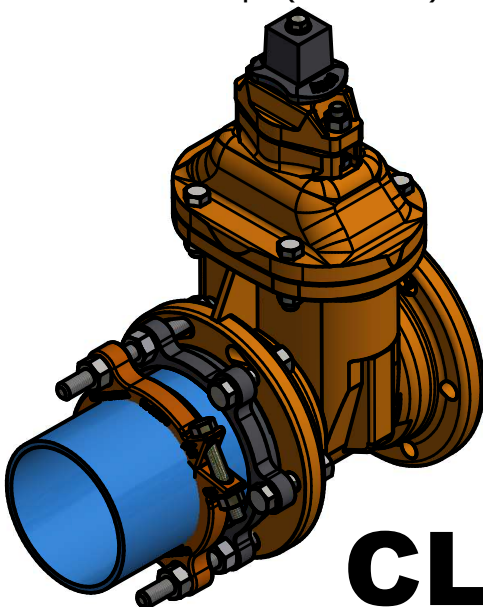

4. SNUG TIGHTEN the restraining nuts behind each clamping ring.

DO NOT OVER TIGHTEN THE CLAMP RESTRAINING RODS

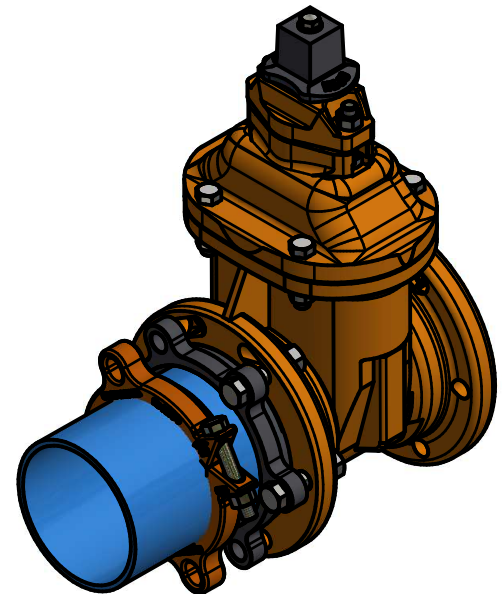

CLOW CANADA